

---

# Easy Fold Ultra Lite



## User Manual

BEFORE using this product, read this manual carefully and save it for future reference.

---

## **Contents**

Introduction.....	1
Quick reference Gide.....	2
Specification.....	4
Practice before operation.....	5
Safety instruction.....	7
Terminology.....	11
Joystick controller operation .....	12
Rear wheel clutch fork.....	17
Fold your wheelchair.....	18
Adjust the controller and armrest.....	19
Remove the battery.....	20
Battery application.....	20

## **Introduction**

**Welcome aboard your new power wheelchair.**

**This model has been designed with your practical needs in mind, equipped with modern high-tech electronics and special features for the most comfortable ride.**

**This manual contains important information regarding the safe use of the power wheelchair.**

**Please read it carefully and ensure you understand all the instructions before attempting to use the vehicle.**

## Easy Fold Ultra Lite

1. Footrest
2. Battery
3. Joystick controller
4. Armrest
5. Handlebar
6. Motor
7. Rear wheel
8. Front wheel

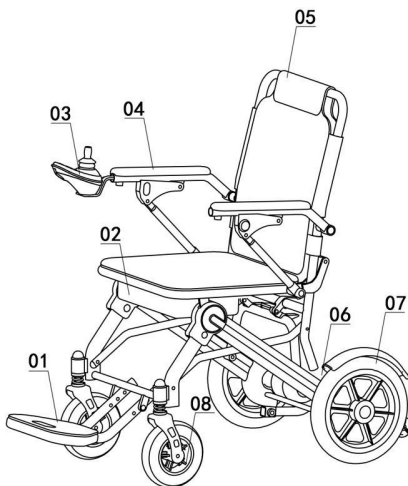

## Quick Reference Guide

1: Remove the wheelchair and spare parts from its packaging. Install the controller to the right or left hand armrest of the driver .



2: Grasp the handlebar and pull the seat cushion frame outwards with your other hand.

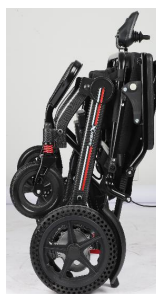

3: Pull out the quick release screw, pull out the anti-tip wheel to the proper position with another hand, and then block it.



4: Connect the plug with the battery under the seat.



5: Pull up the Both Motor clutch fork, keep them on electric operation state. The wheelchair cannot be pushed by hand, and this will prevent the wheels from rolling.

Please refer to the following picture: Pull up to Electric operation



6: Turn On the controller.

## Specification

Model name	Easy Fold Ultra Lite
Whole product size (unfolded)	39.3*23.8*37.4 inch
Net weight (with battery)	39.4 lbs+4.4 lbs (10Ah)
Front wheel	7 inch × 1.2 inch
Rear wheel	11 inch × 1.5 inch
Weight capacity	220 lbs
Forward speed	0-3.7 mph (5 gears adjustable)
Range per charge	≥6.2 miles
Motor	24v/150w × 2 Brushless
Turning radius	23.6 inch
Battery (Lithium)	24V/10AH
Brake	Intelligent Electromagnetic brake
Anti-tip wheel	2 inch×1 inch
Climbing ability	≤ 10 °
Charger	AC100-240V50/60HZ Output: 24V-2A

**Failure to follow the instructions below may result in serious injury or damage to the electric wheelchair.**

**Practice before use.**

Before venturing onto the roads, find an open area such as a park and ask a friend to accompany you until you have mastered the power chair's operation.



The power button should always be off before you get on or off the seat. Set the speed control button appropriate for the vicinity in which you are travelling.

We recommend keeping to a slow speed until you are familiar with handling the wheelchair.

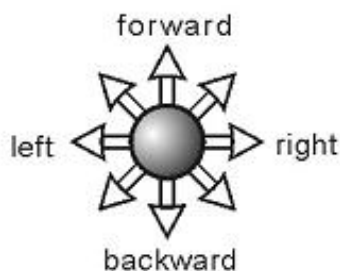

## **Stop, forward, and reverse operations.**

Simply push the joystick gently in the direction you wish to move in.



First, practice moving forward. Be sure to set the speed to the lowest shift.

After you have accomplished moving forwards, practise an "S" turn.



When you can confidently perform these man-oeuvres, try reversing. Pay particular attention to check for obstacles when moving backwards.

**In the event of one of the following errors, immediately turn off the electric wheelchair's power supply:**



- 1、 Sudden movement
- 2、 Operation direction is not controlled
- 3、 Brake failure



## Safety instructions

**Do not** carry passengers.

**Do not** drive across a slope.

**Do not** drive under the influence of alcohol.

**Do not** tailgate another vehicle.

**Do not** operate hand-held communication devices such

as radios or mobile phones.

**Do not** exceed the safe climbing maximum angle.

**Do not** use the joystick in an erratic manner when going up or downhill.

**Do not** exceed the maximum user weight.

**Do not** press the power button of the controller whilst moving as this could damage the electromagnetic brakes or the joystick controller.

**Do not** travel on soft terrain.

**Do not** attempt to climb stairs over two inches tall unless a ramp is installed.

**Do not** disassemble the power wheelchair unless the electromagnetic brakes are engaged and the joystick controller is turned off.

**Do not** operate the power wheelchair without a driver.

**Do not** drive the power wheelchair on the main roads – the footpath must be used.

**Do not** change driving direction or reverse before the power wheelchair has completely stopped.

**Always** engage a slow speed when going down gradients (move the joystick to the central position)

**Always** use the safety belt.

**Always** keep feet on the footrest while travelling.

**Always** make sure the batteries are fully charged before setting out on a journey.

**Always** charge the power wheelchair in a well-ventilated area.

**Always** replace a loose screw from the centre of the wheel with a wrench.

**Reminder!** When using an electric wheelchair, the driver must follow all the rules and regulations of the road.

**NO!**



Make sure there are no obstacles behind when braking; We recommend that the speed is the lowest when reversing.

**NO!**



Avoid emergency braking, irregular shaking or emergency turning.

**NO!**



Keep your arms on or inside the armrest and keep your feet on the footrest.

**NO!**



Do not climb curbs that are more than 5 mm high.

**NO!**



Do not cross a gap that is more than 10 cm wide.

## Precautions when driving on slopes:

Driving on a slope is much more dangerous than driving on a flat surface. Please note the following as falling or losing control will result in serious harm to users and others.

**NO!**



10°

Do not climb slopes that exceed 10°.

**NO!**



10°

Do not reverse when climbing a slope as you may cause a rollover.

**NO!**



Do not drive on the side 3° above the ground.

**NO!**



Do not drive on soft, uneven or unprotected roads such as grass and gravel.

**NO!**



Slow your speed when going downhill. It takes longer to stop the wheelchair when braking downhill.

**NO!**



Do not exit the wheelchair if facing up or down a slope. Stop the wheelchair before getting on and off

## Terminology

**Joystick:** The device used to "move" the power chair.

**Controller:** The device that allows the joystick to function.

**Armrests:** Where arms can rest during time spent on power chair

**Footrest:** Where feet can rest during time spent on the power chair.

**Anti-tip wheels:** Wheels that allow slight tipping, or prevent tipping while driving.

**Rear wheel:** The main wheels that move the power chair.

**Front wheel**

### **WARNING**

Do not disassemble the motor as this may result in severe damage or malfunction.

## **Joystick controller operation**

### **Assemble the controller**

- 1、 Install the controller on the controller connection.
- 2、 Adjust the controller direction then tighten the plum nut.
- 3、 Fix the cabin plug with battery box ;

### **The operation of the controller**

Try to avoid knocking the controller, especially the joystick. Do not beat the controller and the joystick while traveling. Do not hit the controller.

When operating the wheelchair, ensure that the control system is safe and reliable.

### **Operating environment**

Do not keep the control system and its components in a humid environment for long periods of time. If food or drink is spilled on the control system, it should be cleaned immediately.

### **Cleaning**

Use a soft cloth to gently wipe the control system and the joystick.

Do not use abrasives and similar cleaners.

### **Control button**

1: Battery indicator

2: On/off button

3: Horn

4: Speed indicator

5: Acceleration button

6: Deceleration button

7: LED light

8: Joystick

9: USB

10: Charging port

11: LED light

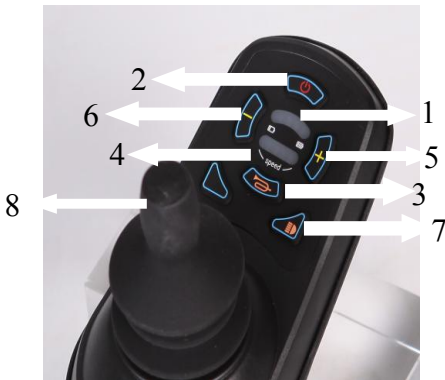

### **On/off button and power display**

The on / off button provides power to the electronic components of the control system to provide power to the wheelchair motor. In an emergency, you can use the on / off button to stop the wheelchair.

The power display shows the current battery power of the wheelchair. The indicator light tells you that the wheelchair is on. At the same time, the power display also shows the status of the wheelchair.

### **Turn on the power**

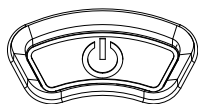

Press the power button  
Both indicators will light up.

### **Turn off the power**

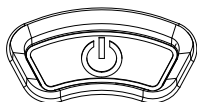

Press the power button  
The indicator light will go off

### **Joystick**

The main function of the joystick is to control the speed and direction of the wheelchair. The further the joystick is moved from a central position, the faster the wheelchair runs. When you release the joystick, the wheelchair automatically brakes.

### **Speed display (S1-S5)**

This display indicates the wheelchair setting. With a total of five settings, S1 is the lowest speed, and S5 is the highest.

### **Horn**

Press the horn to sound an alert.



### **Deceleration button**

This button reduces the speed setting gear and turns the corresponding speed indicator lights off. This button has no effect when driving the wheelchair.

### **Acceleration button**

This button can increase the speed setting gear and the corresponding speed indicator lights on. This button has no effect when driving the wheelchair.

### **LED light**

This button can control the light which under the controller.

### **Self-help guidance**

If a system failure occurs, check the position of the flashing lamp on the speed display and battery indicator. Below are a series of errors which could be indicated by an abnormal sound:

## Controller status indication

Error indication	Malfunction	Solution
All LED lights are off, with no sound	The power is off or in standby, and the power cord is in poor contact.	Check if the power plug is disconnected.
All LED lights are on	The power supply is turned on and the power on self-test passes. The product can be used normally.	Wait for several seconds.
The leftmost red LED is on and the voice alarm	There is an extremely low power supply	Charge the low battery or replace it.
Two long after two short sounds	The left motor has failed.	Check whether the left motor connector is plugged in and the connection is good.
Four long after two short sounds	The right motor has failed.	Check whether the right motor connector is plugged in and the connection is good.
Six long after two short sounds	The controlled is displaying an over-current status	Just after a heavy load, check whether the vehicle exceeds the rated load, then turn it off and restart.
Seven long after two short sounds	There is a joystick problem	When the controller switch is turned on, whether to release the joystick and put the joystick in the center position. After turning the joystick, turn off and on again.
Eight long after two short sounds	The controller is faulty	Replace the controller
Nine long after two short sounds	The controller is faulty	Replace the controller

## Motor clutch fork

When the wheelchair is in the electric operation state (power mode), only the controller can be used to move the wheelchair. The wheelchair cannot be pushed by hand, and this will prevent the wheels from rolling. Manual operation can be triggered by flicking the “motor clutch fork” switch. This means you can easily push the wheelchair, voiding all electronic functions.

Please refer to the following picture:

## Motor Clutch Fork



Pull up, electric operation



Press down, manual operation

## ATTENTION:

It is advisable to keep the wheelchair in the electric operation state. The role of the clutch device is only to allow the wheelchair to be pushed manually in crowded places. **Please keep both clutch forks in same state.**

## Folding your wheelchair

Step 1: Use foot or hand to push the fold button, to make the wheelchair unlock;



Step 2: Hold the handlebar with one hand and the seat cushion frame with the other. Use both hands to force the wheelchair until it is completely folded.



## Adjust the controller

You can install the controller on the left as needed, remove the

controller bracket and install it on the left. And you can control the length by yourself.



### **Armrest**

Press the button on the underside of the armrests to loosen them.

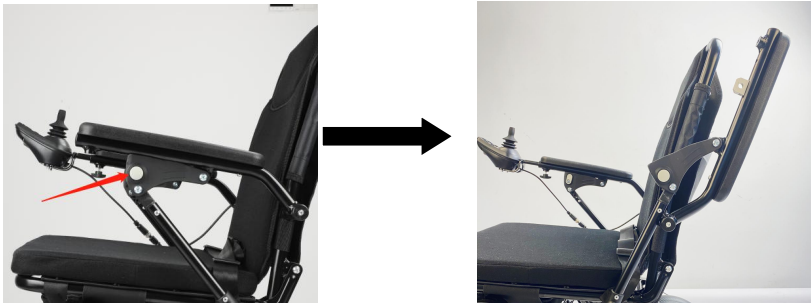

### **Remove the battery**

Unplug the cable of battery, unzip the zipper, and take out the battery



# Battery use

The electric wheelchair uses a 24 voltage battery. It is a good idea to carry a replacement 24V10AH battery, in case you need to charge the one in use. This is a maintenance-free sealed lithium battery. The batteries are designed to handle deep discharges. Although they are similar in performance to car batteries, they cannot be replaced. Car batteries are not safe for use in electric wheelchairs.

# Battery charge and discharge

You can charge the battery directly , or can charge by controller.The wheelchair does not work when charging



When the indicator light of the charger turns green, unplug the plug of the charger,then pull out the power plug.

In order to maximize the efficiency of your wheelchair battery, you should:

1. Fully charge your battery during initial use.
2. Start slowly when using the wheelchair in your home or on the

driveway.

3 . Give your battery charge 4-6 hours, and then re-operate the wheelchair.

4. After 4-5 cycles of charging and discharging, the battery effect can reach 100%, and can continue for a long time.

### **Important information about the battery**

Frequently charged batteries provide reliable performance and long battery life. If the battery is not charged often or not fully charged, it may cause damage to the battery permanently, causing unreliable operation and reduced battery life.

**If you do not often use your electric wheelchair, you must charge once a month to maintain battery life.**

If you want to ship your wheelchair, you must contact the shipping company in advance to ensure that the wheelchair meets the special requirements of the transport.

Maintenance-free fully enclosed lead-acid batteries are designed for wheelchairs and other mobile vehicles. Overall, maintenance-free, fully enclosed lead-acid batteries are safe, green and environmentally friendly, such as aircraft, buses and trains. We recommend that you contact the public transport department for packaging and shipping according to special performance.

Used batteries should be carefully discarded according to your local council's regulations.

### **Charger**

The charger is a very important part of your wheelchair and provides energy to your wheelchair quickly and safely.

Your electric wheelchair is designed to be maintenance free, however we recommend the following checks be completed on a regular basis:

### **Joystick/controller:**

Ensure that the controller is kept away from the damp air as this can easily damage it and void the warranty.

### **Battery cable:**

Check the battery cables to make sure they are not corroded.

### **Clean your wheelchair with a damp cloth:**

Do not use water to clean your wheelchair.