

## In-Use Screen

After a Massage program is selected, In-use screen displays all settings to that program.

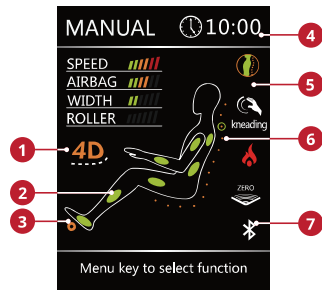

- 1 4D intensity level
- 2 Active airbags
- 3 Active rollers
- 4 Time left
- 5 Indicators
- 6 Back-roller position & direction
- 7 Bluetooth connected

## Air Ionizer

Press the **MENU** button on your remote control to bring up the home display. Select **AIR IONIZER** from Home display, press right button, then press up or down button to select your desired air ionizer setting: On, or Off. Press **OK** button to select the setting.

## Intelligent Voice Control

To turn on the voice control feature on your remote: **Menu > Setting > Voice > On.**

Touch the button on the left speaker, or say **"Switch to voice mode"** to activate voice control commands.

### Use the voice control commands below:

(Once you've activated voice control, give a command within 5 seconds, or you will have to re-activate the voice function.)

- Power On
- Switch Off
- Activate Massage
- Recover
- Stretch
- Back Relief
- Night
- Upper Body
- Lower Body
- Yoga
- Deep Kneading
- Stress Relief
- Massage Extend
- Zero Gravity
- Start Heat
- Heat Off

# KYOTA®

## Quick Start Guide

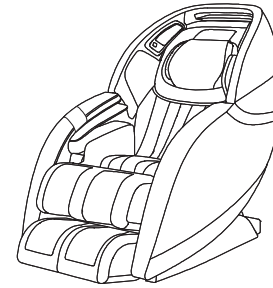

## Kansha M878 4D Massage Chair

**KYOTA** | The World's Most Advanced Massage Chairs®

72 Stard Road, Seabrook, NH 03874 | (800) 242-0761  
www.kyotamassagechairs.com

Version 1.0

# KYOTA®

**Multi-Functional Screen** – Use the directional buttons below to navigate these menu screens. Then press OK to select.

**On/Off** – Powers up the remote or returns the chair to the exit position and powers down remote.

**Menu** – Shortcut to the home page of all menu screens.

**OK** – After navigating to the command desired on the display, push OK to select.

During the massage, press OK button to switch to zero gravity.

**Feet Adjust** – Press and hold up arrow to bring foot rest up, press and hold down arrow to bring foot rest down.

**Feet Extend** – Press and hold to extend the footrest and increase the leg length.

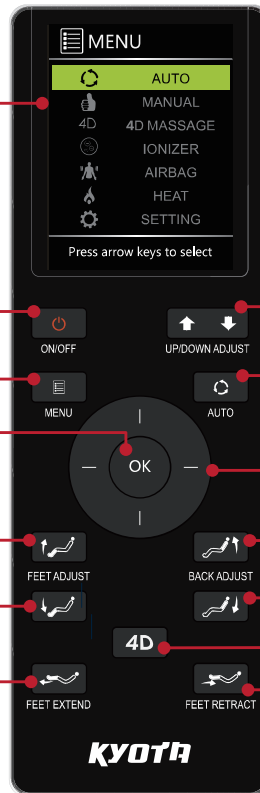

**Back Adjustment** – Back mechanism position adjustment; press and hold up to raise, press and hold down to lower. Use during initial body scan fine tuning or in manual point zone mode.

**Auto** – Select from 6 pre-set auto massage programs.

- Recover
- Stretch
- Back Relief
- Night
- Upper Body
- Lower Body

**Directional Button** – Press up, down, left or right to navigate the display screen.

During the massage, press up or down button to adjust mechanism speed. Press left or right button to adjust airbag force.

**Seat Back Adjust** – Press and hold down arrow to recline the seat back, press and hold the up arrow to upright the seat back.

**4D** – Press to increase or decrease 4D intensity of back mechanism. In-use screen displays intensity dial.

**Feet Retract** – Press and hold to retract the footrest and decrease the leg length.