

Quick Start Guide

GR575 – Patriot



Read before assembly.

Step 1.

Squeeze the tiller adjustment lever (located on the left hand side of the tiller), then raise the tiller up, and release the lever to secure the tiller in the upright position.

Step 2.

Remove the battery shroud. See figure 1.

Step 3.

Carefully lower each battery into the battery tray on the scooter. Make sure that each battery is secured with the hoop and loop straps. Plug each battery into the scooter making sure the connectors are secured. Make sure the freewheel lever is in the engaged position. See figure 1.

Step 4.

Hold the seat at an angle to visually align the seat swivel post, and the seat post on the scooter. Lower the seat swivel post into the seat post. Push down to make sure it is seated securely and unable to move side to side. Push down on the swivel handle and move the seat so that it is facing in the forward position if not already there. See figure 2.

Step 5.

Insert each arm into the arm receiver tube at the bottom rear of the seat frame. Adjust the width of each arm. Install and tighten each arm width adjustment knob to secure each arm in place. See figure 3.

Step 6.

Sit on the seat, facing forward, insert key and turn the key to the right. Verify that the battery meter on the dash illuminates indicating power on and that the scooter is not beeping. If it is beeping, count the number of beeps, and refer to your owner's manual to determine the problem. If the battery meter is illuminated and the scooter is not beeping, your scooter is assembled correctly, and you are ready to ride.

NOTICE

New batteries must be fully charged prior to the initial use of the product. Connect the charger to the scooter first, then the wall outlet, and charge the batteries for 12 hours before using the product.

Step 7.

(Optional) Connect the accessory bracket to the arm receiver tube. Only use the supplied hardware and mount through the predrilled holes located at the rear of the seat. See figure 3.

Fig.1

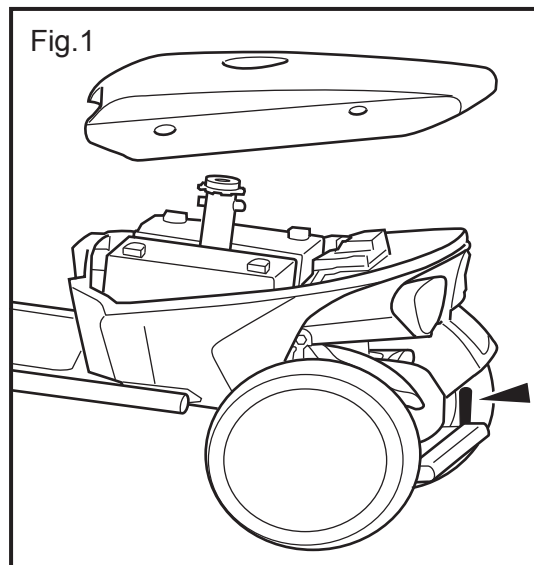

Fig.2

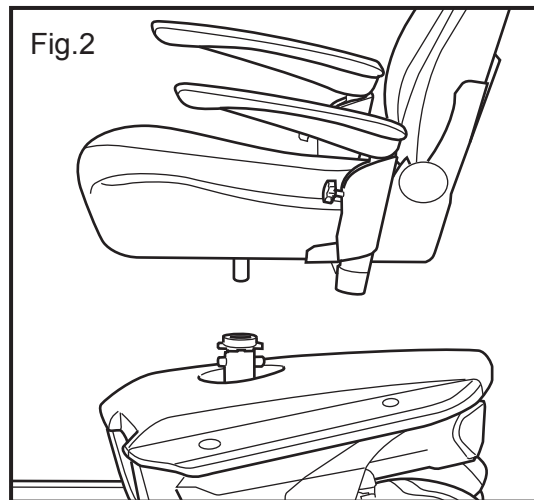

Fig.3

